

FENCING / PEDESTRIAN ACCESS PLAN

MUIR & WILSON PARKING PROJECT

REV 8-29-14

NO.	DATE	DESCRIPTION

UNDERWOOD & ROSENBLUM, INC.
civil engineers and surveyors
1300 & 1444 Williams Street
San Leandro, CA 94577

Parking Lots Improvements
Woodrow Wilson Elementary and Muir Middle Schools
1300 & 1444 Williams Street
San Leandro, CA 94577

OVERALL PLAN

Date 7-28-2014
Scale 1"=50'
Dwn by: MM,VQ
Checked: VQ
Job J14010
Sheet
P-C0

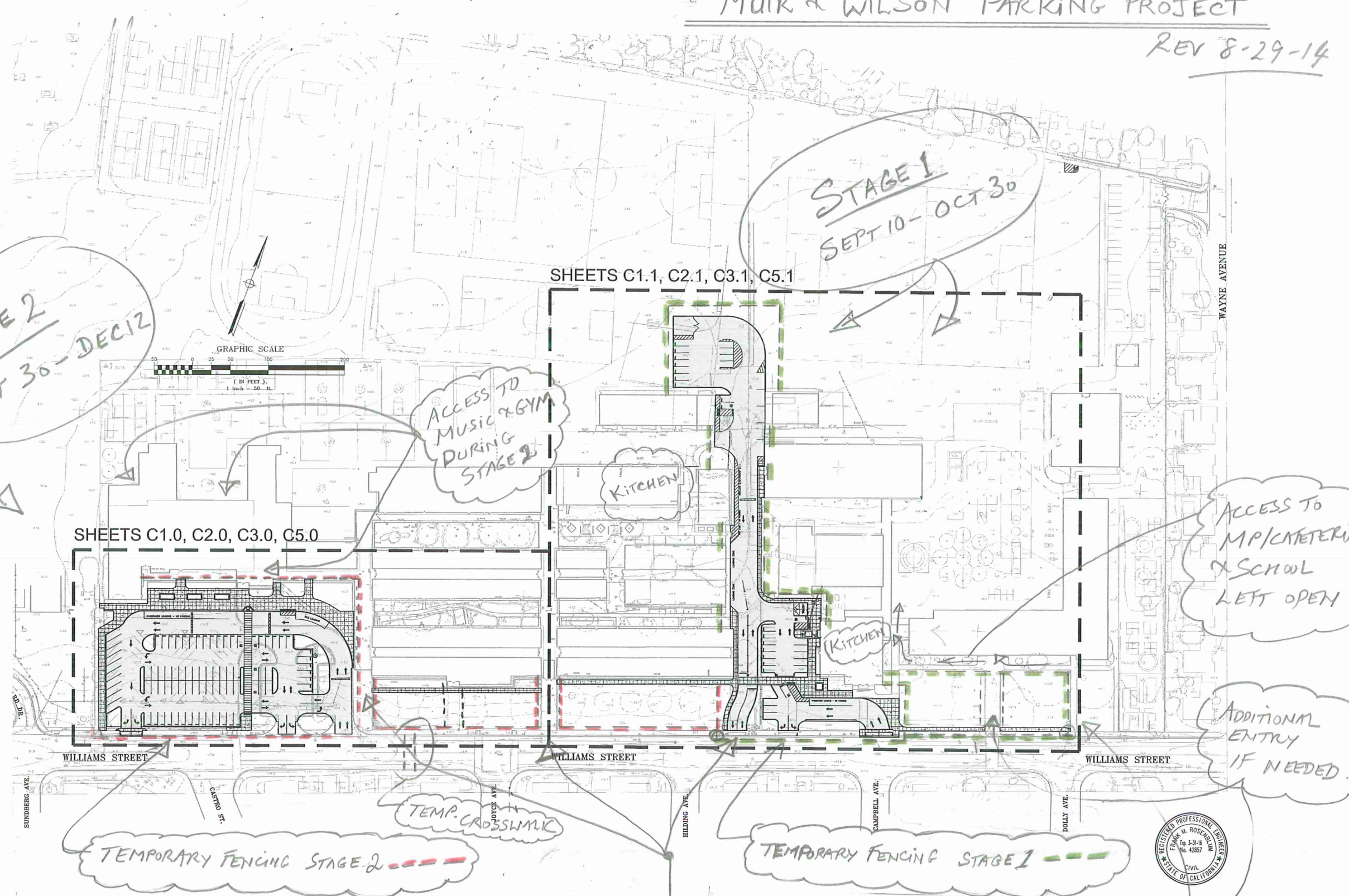

- ENTRIES TO MUIR DURING STAGE 2
- ACCESS TO MUSIC & GYM VIA BREEZWAY OR REAR DOORS ON NORTH.
- CREATION OF TEMPORARY CROSSWALK @ MUIR INVESTIGATED + FLAGMAN.

- ENTRY TO WILSON @ STAGE 1

